

SERIES S 20 | LINE REGULATOR

- Bellow single stage
- Purity up to 6.0
- Inlet pressure:
50 bar (725 psi)
- Outlet pressure:
1/3/10 bar
14.5/44/145 psi

- ★ Accurate pressure delivery
- ★ Compact design
- ★ 2 inlets / 2 outlet
- ★ Rear Inlet for panel mounting
- ★ O₂ application compatible (see technical data)

Special requirements on request

APPLICATIONS

- Used as a line or point of use regulator for specialty gas applications requiring very precise repeatability and a high precision of outlet pressure
- Ideally suited for laboratory applications like: gas delivery to inductive plasma spectrometer, protection and support gas for chromatograph.

KEY FEATURES

- Bellow technology provides a large range of accurate outlet pressures in a compact design.
- With its compact design, the rear threads and its fixing ring (option) it can be used for wall or panel mounting.
- Acetylene version available: Series S 20 AD & S 25 AD (See pages 66 and 68)

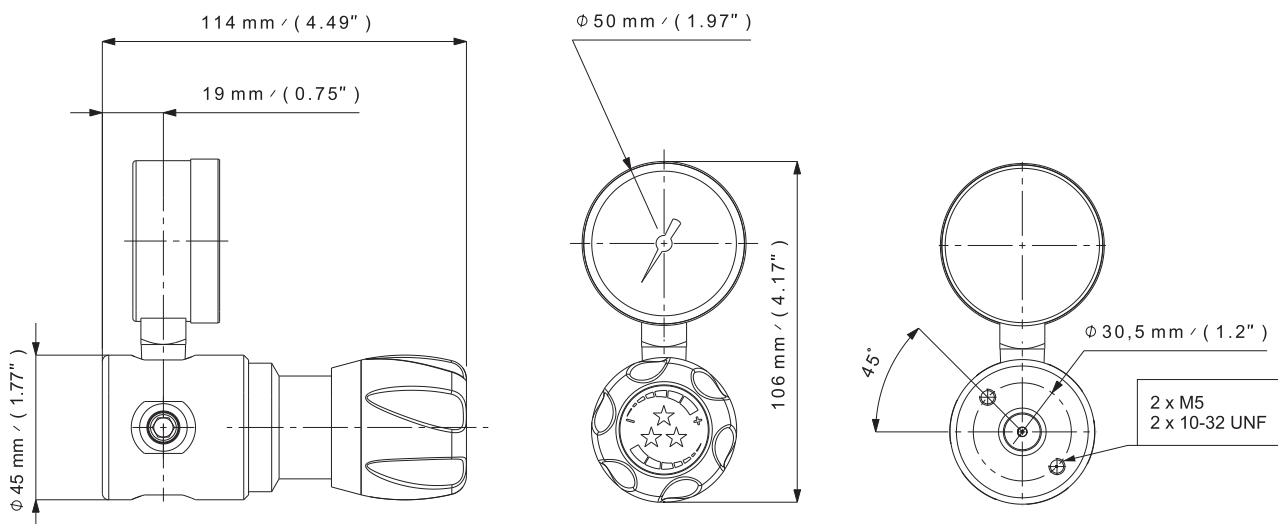

Drawing for 1/4 NPT version

SPECIFICATIONS

Female ports	G 3/8 or 1/4 NPT (inlet/outlet)	Weight	± 0,5 kg ± 1.1 lbs	Inlet pressure	50 bar 725 psi
Seat seal	EPDM	Leak rate	10 ⁻⁸ mbar ℓ/s He	Outlet pressure	1/3/10 bar 14.5/44/145 psi
O-ring	EPDM - Standard NBR FPM	Temperature range	- 20°C to + 60°C - 4°F to + 140°F	Nominal Flow	2/2,5/3,5 Nm³/h (N ₂)
Bellow	Bronze or AISI 316L (SS version)	Gauges	Low pressure (M10 x 1 or 1/4 NPT)	Oxygen use	inlet pressure ≤ 30 bar max. for brass and stainless steel

FLOW CURVES

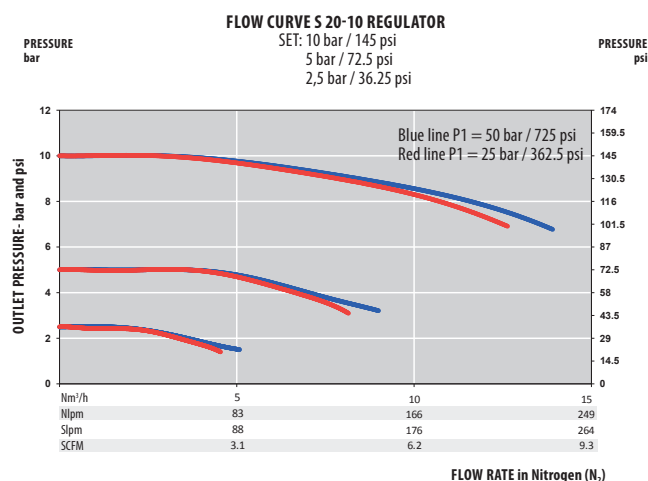
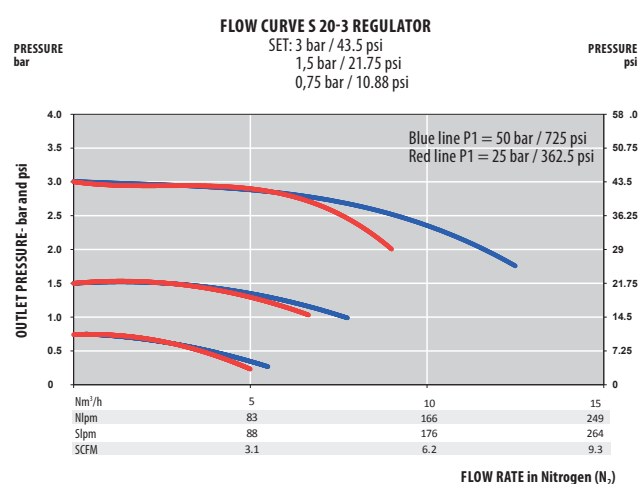
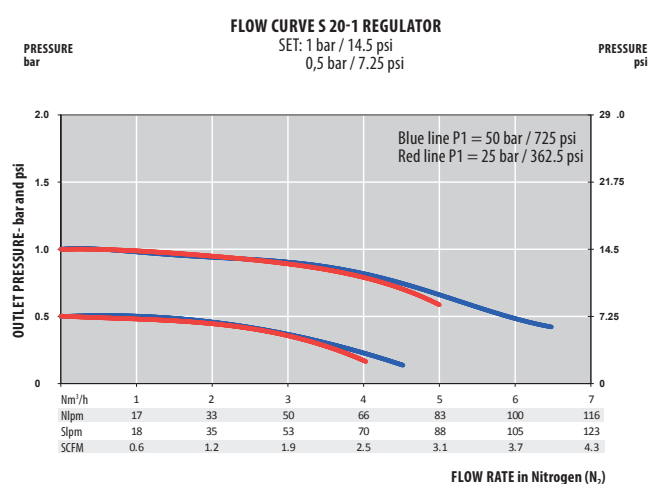

PRODUCT CONFIGURATOR

Body Material			Outlet Pressure		End Connections		O-ring Material	Gauge		Mounting		Ports Configuration		
S	L		20	10	G		EPDM	1	FR0		A			
	Chrome plated brass	L		1 bar 14.5 psi	1	G 3/8 - G 3/8	G	EPDM - Standard	Without	0	Without Fixing Ring	FR0	Standard Configuration	A
	Stainless steel	I		3 bar 44 psi	3	1/4 NPT - 1/4 NPT	N	NBR	With	1	With Fixing Ring	FR1	Reverse inlet/outlet	R
				10 bar 145 psi	10			FPM						



WolfLabs

Pricing on any accessories shown can be found by keying the part number into the search box on our website.

The specifications listed in this brochure are subject to change by the manufacturer and therefore cannot be guaranteed to be correct. If there are aspects of the specification that must be guaranteed, please provide these to our sales team so that details can be confirmed.

www.wolflabs.co.uk

Tel : 01759 301142

Fax : 01759 301143

sales@wolflabs.co.uk

Please contact us if this literature doesn't answer all your questions.